

| [row] | Status | PartyType | FullName | CrossPartyName | RecordDate | Doc Type | Book Type | Book | Page | Remarks | Instrument | Township | Lot | Block | Unit | Sub | FreeForm | Filing# | Section | Range | Con | |
|-------|--------|-----------|----------|--------------------------------------|------------|-----------|-----------|------|------|---------|------------|----------|-----|-------|--------|-----|-----------------|---------|---------|-------|------|----------------|
| 451 | | From | MERS INC | TAYLOR BEAN & WHITAKER MORTGAGE CORP | 9/19/2008 | AFFIDAVIT | OPR | | | | 2008064432 | | | | | | | | | | | |
| 452 | | To | MERS INC | CHICAGO TITLE OF COLORADO INC | 9/22/2008 | AFFIDAVIT | OPR | | | | 2008064712 | | | | 206 | | | | | | | SAWK FLUM CONC |
| 453 | | From | MERS INC | KENNEDY DONNA | 9/22/2008 | AFFIDAVIT | OPR | | | | 2008064657 | | | | | | | | | | | |
| 454 | | To | MERS INC | MERS INC | 9/22/2008 | AFFIDAVIT | OPR | | | | 2008064657 | | | | | | | | | | | |
| 455 | | From | MERS INC | TAYLOR BEAN & WHITAKER MORTGAGE CORP | 10/27/2008 | AFFIDAVIT | OPR | | | | 2008072265 | | | | 14-303 | | | | | | | IRON: CONC |
| 456 | | To | MERS INC | LAWYERS TITLE INSURANCE CORP | 11/12/2008 | AFFIDAVIT | OPR | | | | 2008075721 | | | | | | | | | | | |
| 457 | | To | MERS INC | SPRIGG GREG M | 11/25/2008 | AFFIDAVIT | OPR | | | | 2008080406 | | 7 | | | | PINERY | | | | 23A | |
| 458 | | From | MERS INC | GILLEN KEVIN R | 12/1/2008 | AFFIDAVIT | OPR | | | | 2008080758 | | | | | | | | | | | |
| 459 | | To | MERS INC | MERS INC | 12/1/2008 | AFFIDAVIT | OPR | | | | 2008080758 | | | | | | | | | | | |
| 460 | | From | MERS INC | HARDEMAN HUBBERT S | 12/1/2008 | AFFIDAVIT | OPR | | | | 2008080759 | | | | | | | | | | | |
| 461 | | To | MERS INC | MERS INC | 12/1/2008 | AFFIDAVIT | OPR | | | | 2008080759 | | | | | | | | | | | |
| 462 | | From | MERS INC | BYUS DARREN ROY | 1/12/2009 | AFFIDAVIT | OPR | | | | 2009001701 | | 6 | | | | HIGHLANDS RANCH | | | | 118B | |
| 463 | | To | MERS INC | MERS INC | 1/23/2009 | AFFIDAVIT | OPR | | | | 2009003910 | | | | | | | | | | | |
| 464 | | From | MERS INC | HANSON ANY A | 1/23/2009 | AFFIDAVIT | OPR | | | | 2009003910 | | | | | | | | | | | |
| 465 | | To | MERS INC | LITTON LOAN SERVICING LP | 2/13/2009 | AFFIDAVIT | OPR | | | | 2009008840 | | | | | | | | | | | |

Search Results

Searched for the name 'MERS' in AFFI type documents from '1/1/1874' to '7/21/2012'

| [row] | Status | PartyType | FullName | CrossPartyName | RecordDate | Doc Type | Book Type | Book | Page | Remarks | Instrument | Township | Lot | Block | Unit | Sub | FreeForm | Filing# | Section | Range | Con |
|-------|--------|-----------|----------|-------------------------------|------------|-----------|-----------|------|------|---------|------------|----------|-----|-------|------|-----|-----------------|---------|---------|-------|-----|
| 466 | | To | MERS INC | LITTON LOAN SERVICING LP | 2/27/2009 | AFFIDAVIT | OPR | | | | 2009013462 | | | | | | | | | | |
| 467 | | From | MERS INC | HIRSCH JANICE A TRUSTEE | 3/4/2009 | AFFIDAVIT | OPR | | | | 2009014560 | | | | | | | | | | |
| 468 | | To | MERS INC | MERS INC | 3/4/2009 | AFFIDAVIT | OPR | | | | 2009014560 | | | | | | | | | | |
| 469 | | To | MERS INC | CHICAGO TITLE OF COLORADO INC | 3/23/2009 | AFFIDAVIT | OPR | | | | 2009019758 | | 78 | | | | CHATFIELD FARMS | | | 1A | |
| 470 | | To | MERS INC | CHICAGO TITLE OF COLORADO INC | 4/28/2009 | AFFIDAVIT | OPR | | | | 2009030273 | | | | | | | | | | |
| 471 | | To | MERS INC | CHICAGO TITLE OF COLORADO INC | 5/1/2009 | AFFIDAVIT | OPR | | | | 2009032163 | | 242 | | | | HIGHLANDS RANCH | | | 122T | |
| 472 | | To | MERS INC | FREEDOM LENDING LLC | 5/5/2009 | AFFIDAVIT | OPR | | | | 2009032912 | | | | | | | | | | |
| 473 | | From | MERS INC | ROBILLARD DANIEL | 5/14/2009 | AFFIDAVIT | OPR | | | | 2009036581 | | | | | | | | | | |
| 474 | | From | MERS INC | KAMINSKY ANATOLY | 5/26/2009 | AFFIDAVIT | OPR | | | | 2009039268 | | | | | | | | | | |
| 475 | | To | MERS INC | MERS INC | 5/26/2009 | AFFIDAVIT | OPR | | | | 2009039268 | | | | | | | | | | |
| 476 | | From | MERS INC | SANDERSON GEORGE L JR | 6/5/2009 | AFFIDAVIT | OPR | | | | 2009043660 | | | | | | | | | | |
| 477 | | To | MERS INC | MERS INC | 6/5/2009 | AFFIDAVIT | OPR | | | | 2009043660 | | | | | | | | | | |
| 478 | | From | MERS INC | COFIELD GREGORY R | 7/10/2009 | AFFIDAVIT | OPR | | | | 2009055038 | | | | | | | | | | |
| 479 | | To | MERS INC | MERS INC | 7/10/2009 | AFFIDAVIT | OPR | | | | 2009055038 | | | | | | | | | | |
| 480 | | To | MERS INC | LITTON LOAN SERVICING LP | 8/13/2009 | AFFIDAVIT | OPR | | | | 2009065263 | | | | | | | | | | |

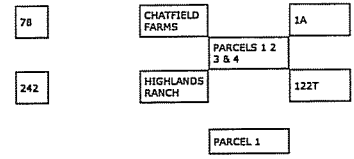

Search Results

Searched for the name 'MERS' in AFFI type documents from '1/1/1874' to '7/21/2012'

| ... 29 30 31 32 33 34 35 36 37 38 | | | | | | | | | | | | | | | | | | | | | |
|-----------------------------------|--------|-----------|------------|---|------------|-----------|-----------|------|------|---------|------------|----------|-----|-------|------|----------------------|----------|---------|---------|-------|-----------------------|
| [row] | Status | PartyType | FullName ▲ | CrossPartyName | RecordDate | Doc Type | Book Type | Book | Page | Remarks | Instrument | Township | Lot | Block | Unit | Sub | FreeForm | Filing# | Section | Range | Condo |
| 496 | | From | MERS INC | COURINGTON STEVEN N | 12/2/2009 | AFFIDAVIT | OPR | | | | 2009091094 | | 31 | | | LONE TREE | | 6B | | | |
| 497 | | To | MERS INC | MERS INC | 12/2/2009 | AFFIDAVIT | OPR | | | | 2009091094 | | 31 | | | LONE TREE | | 6B | | | |
| 498 | | From | MERS INC | CHAVIRA MARCUS | 12/23/2009 | AFFIDAVIT | OPR | | | | 2009099203 | | | | | | | | | | |
| 499 | | To | MERS INC | AFFILIATED FINANCIAL GROUP LLC | 12/28/2009 | AFFIDAVIT | OPR | | | | 2009100027 | | | | | | | | | | |
| 500 | | To | MERS INC | FIDELITY NATIONAL TITLE GROUP | 12/30/2009 | AFFIDAVIT | OPR | | | | 2009100763 | | | | | U | | | | | STONEG PARK GL CONDOM |
| 501 | | To | MERS INC | GMAC MORTGAGE LLC | 1/4/2010 | AFFIDAVIT | OPR | | | | 2010000044 | | 13 | 2 | | CRYSTAL VALLEY RANCH | | 1 | | | |
| 502 | | To | MERS INC | DOUGLAS COUNTY CLERK AND RECORDERS OFFICE | 1/6/2010 | AFFIDAVIT | OPR | | | | 2010000819 | | | | | | | | | | |
| 503 | | From | MERS INC | COFIELD GREGORY R | 1/19/2010 | AFFIDAVIT | OPR | | | | 2010003074 | | | | | | | | | | |
| 504 | | To | MERS INC | MERS INC | 1/19/2010 | AFFIDAVIT | OPR | | | | 2010003074 | | | | | | | | | | |
| 505 | | To | MERS INC | LAND TITLE GUARANTEE CO | 1/27/2010 | AFFIDAVIT | OPR | | | | 2010005327 | | 3 | B | | FERRY PARK | | 5 | | | |
| 506 | | To | MERS INC | QUICKEN LOANS INC | 2/1/2010 | AFFIDAVIT | OPR | | | | 2010006078 | | | | | | | | | | |
| 507 | | To | MERS INC | BERLIN MELINDA F | 2/5/2010 | AFFIDAVIT | OPR | | | | 2010007604 | | | | | | | | | | |
| 508 | | From | MERS INC | PETER CHRISTOPHER MARK | 2/10/2010 | AFFIDAVIT | OPR | | | | 2010008422 | | | | | | | | | | |
| 509 | | To | MERS INC | MERS INC | 2/10/2010 | AFFIDAVIT | OPR | | | | 2010008422 | | | | | | | | | | |
| 510 | | From | MERS INC | HERTZBERG THOMAS A | 5/13/2010 | AFFIDAVIT | OPR | | | | 2010029505 | | | | | | | | | | |
| ... 29 30 31 32 33 34 35 36 37 38 | | | | | | | | | | | | | | | | | | | | | |

Search Results

Showing 511 - 525 of 567

Searched for the name 'MERS' in AFFI type documents from '1/1/1874' to '7/21/2012'

| ... 29 30 31 32 33 34 35 36 37 38 | | | | | | | | | | | | | | | | | | | | | |
|-----------------------------------|--------|-----------|----------|-----------------------------------|------------|-----------|-----------|------|------|---------|------------|----------|-----|-------|------|-------------------------|----------|---------|---------|-------|----|
| [row] | Status | PartyType | FullName | CrossPartyName | RecordDate | Doc Type | Book Type | Book | Page | Remarks | Instrument | Township | Lot | Block | Unit | Sub | FreeForm | Filing# | Section | Range | Co |
| 511 | | From | MERS INC | SMITH GREGORY S | 7/8/2010 | AFFIDAVIT | OPR | | | | 2010041984 | | 40 | 1 | | CLARKE FARMS | | 1 | | | |
| 512 | | To | MERS INC | ATTORNEYS TITLE GUARANTY FUND INC | 7/29/2010 | AFFIDAVIT | OPR | | | | 2010046262 | | 7 | 2 | | CASTLEWOOD RANCH | PARCEL 6 | 1 | | | |
| 513 | | To | MERS INC | OCWEN LOAN SERVICING LLC | 8/23/2010 | AFFIDAVIT | OPR | | | | 2010052175 | | 108 | | | ACRES GREEN | | 4 | | | |
| 514 | | From | MERS INC | SWEERS JEFFREY JOSEPH | 9/21/2010 | AFFIDAVIT | OPR | | | | 2010060553 | | | | | | | | | | |
| 515 | | From | MERS INC | MURRAY JASON W | 9/21/2010 | AFFIDAVIT | OPR | | | | 2010060554 | | | | | | | | | | |
| 516 | | From | MERS INC | HOFFMAN PAUL A | 9/21/2010 | AFFIDAVIT | OPR | | | | 2010060555 | | | | | | | | | | |
| 517 | | From | MERS INC | WR STARKEY MORTGAGE LLP | 10/4/2010 | AFFIDAVIT | OPR | | | | 2010064594 | | | | | | | | | | |
| 518 | | To | MERS INC | MERS INC | 10/4/2010 | AFFIDAVIT | OPR | | | | 2010064594 | | | | | | | | | | |
| 519 | | To | MERS INC | CASTLE MEINHOLD & STAWIARSKI LLC | 10/11/2010 | AFFIDAVIT | OPR | | | | 2010066745 | 10 | | | | | | | 25 | 70 | |
| 520 | | From | MERS INC | SCOTT MARC | 10/15/2010 | AFFIDAVIT | OPR | | | | 2010067893 | | 2 | 5 | | BRADBURY RANCH | | 1 | | | |
| 521 | | To | MERS INC | MERS INC | 10/15/2010 | AFFIDAVIT | OPR | | | | 2010067893 | | 2 | 5 | | BRADBURY RANCH | | 1 | | | |
| 522 | | From | MERS INC | DONIPARTHI BHOOFATHI | 10/18/2010 | AFFIDAVIT | OPR | | | | 2010068260 | | | | | | | | | | |
| 523 | | From | MERS INC | MAYNARD MARK D | 10/25/2010 | AFFIDAVIT | OPR | | | | 2010070354 | | | | | | | | | | |
| 524 | | To | MERS INC | OCWEN LOAN SERVICING LLC | 11/4/2010 | AFFIDAVIT | OPR | | | | 2010075816 | | 59 | 10 | | CHALLENGER PARK ESTATES | | 2 | | | |
| 525 | | From | MERS INC | WEST KRISTINE | 11/18/2010 | AFFIDAVIT | OPR | | | | 2010080728 | | 4 | 2 | | TOWN & COUNTRY VILLAGE | | 3 | | | |
| ... 29 30 31 32 33 34 35 36 37 38 | | | | | | | | | | | | | | | | | | | | | |

Search Results

Searched for the name 'MERS' in AFFI type documents from '1/1/1874' to '7/21/2012'

| ... 29 30 31 32 33 34 35 36 37 38 | | | | | | | | | | | | | | | | | | | | | |
|-----------------------------------|--------|-----------|----------|--------------------------|------------|-----------|-----------|------|------|---------|------------|----------|-----|-------|------|------------------------|----------|---------|---------|-------|-----|
| [row] | Status | PartyType | FullName | CrossPartyName | RecordDate | Doc Type | Book Type | Book | Page | Remarks | Instrument | Township | Lot | Block | Unit | Sub | FreeForm | Filing# | Section | Range | Con |
| 526 | | To | MERS INC | COLDWELL BANKER MORTGAGE | 11/18/2010 | AFFIDAVIT | OPR | | | | 2010080728 | | 4 | 2 | | TOWN & COUNTRY VILLAGE | | 3 | | | |
| 527 | | From | MERS INC | KEYSER L GARY | 11/22/2010 | AFFIDAVIT | OPR | | | | 2010081721 | | | | | | | | | | |
| 528 | | To | MERS INC | MERS INC | 11/22/2010 | AFFIDAVIT | OPR | | | | 2010081721 | | | | | | | | | | |
| 529 | | To | MERS INC | MERS INC | 11/22/2010 | AFFIDAVIT | OPR | | | | 2010081722 | | | | | | | | | | |
| 530 | | From | MERS INC | FAJFER THOMAS A | 11/22/2010 | AFFIDAVIT | OPR | | | | 2010081722 | | | | | | | | | | |
| 531 | | From | MERS INC | ARNOLD ELIOT C | 12/13/2010 | AFFIDAVIT | OPR | | | | 2010087971 | | 14 | 5 | | STONEGATE | | 5A | | | |
| 532 | | From | MERS INC | HASHENBERGER MATTHEW W | 12/20/2010 | AFFIDAVIT | OPR | | | | 2010089939 | | | | | | | | | | |
| 533 | | To | MERS INC | MERS INC | 12/20/2010 | AFFIDAVIT | OPR | | | | 2010089939 | | | | | | | | | | |
| 534 | | From | MERS INC | BRONSON NEVETS R | 1/10/2011 | AFFIDAVIT | OPR | | | | 2011002672 | | 36 | 4 | | HIGHLANDS RANCH | | 17 | | | |
| 535 | | From | MERS INC | QUATTLEBAUM GABRIELLE D | 1/19/2011 | AFFIDAVIT | OPR | | | | 2011004760 | | | | | | | | | | |
| 536 | | To | MERS INC | MERS INC | 1/19/2011 | AFFIDAVIT | OPR | | | | 2011004760 | | | | | | | | | | |
| 537 | | From | MERS INC | PEREZ MARLOW | 5/20/2011 | AFFIDAVIT | OPR | | | | 2011031657 | | | | | | | | | | |
| 538 | | From | MERS INC | VECTRA BANK COLORADO | 7/19/2011 | AFFIDAVIT | OPR | | | | 2011043161 | | | | | | | | | | |
| 539 | | To | MERS INC | MERS INC | 7/19/2011 | AFFIDAVIT | OPR | | | | 2011043161 | | | | | | | | | | |
| 540 | | From | MERS INC | PRATT SARAH L | 7/22/2011 | AFFIDAVIT | OPR | | | | 2011044259 | | 44C | | | HIGHLANDS RANCH | | 118G | | | |
| ... 29 30 31 32 33 34 35 36 37 38 | | | | | | | | | | | | | | | | | | | | | |

Search Results

Searched for the name 'MERS' in AFFI type documents from '1/1/1874' to '7/21/2012'

| ... 29 30 31 32 33 34 35 36 37 38 | | | | | | | | | | | | | | | | | | | | | |
|-----------------------------------|--------|-----------|------------|-------------------------------|------------|-----------|-----------|------|------|---------|------------|----------|-----|-------|------|------------------|----------|---------|---------|-------|----------------|
| [row] | Status | PartyType | FullName ▲ | CrossPartyName | RecordDate | Doc Type | Book Type | Book | Page | Remarks | Instrument | Township | Lot | Block | Unit | Sub | FreeForm | Filing# | Section | Range | Con |
| 541 | | From | MERS INC | PLAZA HOME MORTGAGE INC | 8/5/2011 | AFFIDAVIT | OPR | | | | 2011047395 | | 44C | | | HIGHLANDS RANCH | | 118G | | | |
| 542 | | To | MERS INC | MERS INC | 8/5/2011 | AFFIDAVIT | OPR | | | | 2011047395 | | 44C | | | HIGHLANDS RANCH | | 118G | | | |
| 543 | | To | MERS INC | CASTLE STAWIARSKI LLC | 8/30/2011 | AFFIDAVIT | OPR | | | | 2011052484 | | 31 | 1 | | HIGHLANDS RANCH | | 53A | | | |
| 544 | | To | MERS INC | CASTLE STAWIARSKI LLC | 8/30/2011 | AFFIDAVIT | OPR | | | | 2011052490 | | 17 | 8 | | FOUNDERS VILLAGE | | 3 | | | |
| 545 | | To | MERS INC | VANDER POL JONATHAN A | 9/15/2011 | AFFIDAVIT | OPR | | | | 2011055528 | | | | | | | | | | |
| 546 | | To | MERS INC | AMERICAN LIBERTY MORTGAGE INC | 9/21/2011 | AFFIDAVIT | OPR | | | | 2011056844 | | | | | | | | | | |
| 547 | | To | MERS INC | JONES MARK C | 11/9/2011 | AFFIDAVIT | OPR | | | | 2011070626 | | | | 203 | | | | | | SHAD CANY CONE |
| 548 | | To | MERS INC | FLAGSTAR BANK | 12/20/2011 | AFFIDAVIT | OPR | | | | 2011080249 | | 7 | | | HIGHLANDS RANCH | | 78D | | | |
| 549 | | To | MERS INC | PINNACLE MORTGAGE GROUP INC | 1/23/2012 | AFFIDAVIT | OPR | | | | 2012004795 | | | | | | | | | | |
| 550 | | From | MERS INC | GRUBENHOFF MARY BETH | 1/24/2012 | AFFIDAVIT | OPR | | | | 2012005178 | | | | | | | | | | |
| 551 | | To | MERS INC | MERS INC | 1/24/2012 | AFFIDAVIT | OPR | | | | 2012005178 | | | | | | | | | | |
| 552 | | From | MERS INC | THERWHANGER WADE L | 1/24/2012 | AFFIDAVIT | OPR | | | | 2012005179 | | | | | | | | | | |
| 553 | | To | MERS INC | MERS INC | 1/24/2012 | AFFIDAVIT | OPR | | | | 2012005179 | | | | | | | | | | |
| 554 | | To | MERS INC | CITIMORTGAGE INC | 2/8/2012 | AFFIDAVIT | OPR | | | | 2012009368 | | 2 | 5 | | MAHER RANCH | 2009CV68 | 2 | | | |
| 555 | | From | MERS INC | KRAFT GREGORY A | 3/14/2012 | AFFIDAVIT | OPR | | | | 2012018898 | | | | | | | | | | |
| ... 29 30 31 32 33 34 35 36 37 38 | | | | | | | | | | | | | | | | | | | | | |

Searched for the name 'MERS' in AFFI type documents from '1/1/1874' to '7/21/2012'

| ... 29 30 31 32 33 34 35 36 37 38 | | | | | | | | | | | | | | | | | | | | | |
|-----------------------------------|--------|-----------|----------------------------------|----------------|------------|-----------|-----------|------|------|---------|------------|----------|-----|-------|------|-----|-----------------|---------|---------|-------|-----|
| [row] | Status | PartyType | FullName ▲ | CrossPartyName | RecordDate | Doc Type | Book Type | Book | Page | Remarks | Instrument | Township | Lot | Block | Unit | Sub | FreeForm | Filing# | Section | Range | Con |
| 556 | To | MERS INC | MERS INC | MERS INC | 3/14/2012 | AFFIDAVIT | OPR | | | | 2012018898 | | | | | | | | | | |
| 557 | From | MERS INC | LESSER PAUL C D | MERS INC | 3/14/2012 | AFFIDAVIT | OPR | | | | 2012018937 | | | | | | | | | | |
| 558 | To | MERS INC | MERS INC | MERS INC | 3/14/2012 | AFFIDAVIT | OPR | | | | 2012018937 | | | | | | | | | | |
| 559 | To | MERS INC | SIENNA NATIONAL TITLE AGENCY LLC | MERS INC | 3/20/2012 | AFFIDAVIT | OPR | | | | 2012020568 | | 180 | 1 | | | RED HAWK | | 1 | | |
| 560 | To | MERS INC | CASTLE STAWIARSKI LLC | MERS INC | 3/30/2012 | AFFIDAVIT | OPR | | | | 2012023419 | | 36 | 1 | | | RAMPART STATION | | 1 | | |
| 561 | To | MERS INC | WELLS FARGO BANK | MERS INC | 6/6/2012 | AFFIDAVIT | OPR | | | | 2012040751 | | 21 | 1 | | | STONEGATE | | 1C | | |
| 562 | From | MERS INC | HOSSELKUS KENNETH D | MERS INC | 6/20/2012 | AFFIDAVIT | OPR | | | | 2012044412 | | | | | | | | | | |
| 563 | From | MERS INC | CRUMP CHRIS A | MERS INC | 6/22/2012 | AFFIDAVIT | OPR | | | | 2012045181 | | | | | | | | | | |
| 564 | To | MERS INC | MERS INC | MERS INC | 6/22/2012 | AFFIDAVIT | OPR | | | | 2012045181 | | | | | | | | | | |
| 565 | From | MERS INC | US BANK TRUST | MERS INC | 6/25/2012 | AFFIDAVIT | OPR | | | | 2012045499 | | | | | | | | | | |
| 566 | From | MERS INC | US BANK TRUST | MERS INC | 6/25/2012 | AFFIDAVIT | OPR | | | | 2012045498 | | | | | | | | | | |
| 567 | To | MERS INC | MIKESSELL ADAM C | MERS INC | 7/12/2012 | AFFIDAVIT | OPR | | | | 2012050130 | | 5 | 2 | | | HIGHLANDS RANCH | | 74A | | |
| ... 29 30 31 32 33 34 35 36 37 38 | | | | | | | | | | | | | | | | | | | | | |

